

# GMV-5 MACHINE QUOTATION

# GMV-5 (12"X 58") Heavy-Duty Knee-Mill Milling Table with Extended Support

## STANDARD MACHINE FEATURES:

### Machine Construction:

- Meehanite Castings, fine grain and high density cast iron using the superior Meehanite process provides superior vibration dampening and improved surface finish and tool life
- **Oversized table support casting provides superior workpiece stabilization & rigidity**
- **Dual X-Axis gibs are Turcite-B coated and pressure lubricated double-end style**
- **Extended table support casting provides increased X-axis accuracy by reducing rollover error**
- Built-in leveling ledge to make leveling the machine low to ground very easy

### Guide Ways:

- Hardened and Ground extra wide Box Way saddle for heavy-duty cutting performance
- Hardened and Ground Square Box Ways on Column and Knee
- Hardened and Ground Machine Table and T-Slots for enhanced wear resistance
- Dovetail ways for longitudinal axis.
- Turcite-B Premium *Red Furon* Coated way surfaces

### Spindle:

- 5-HP Spindle Motor
- Precision Spindle with 0.0002" maximum spindle runout.
- ABEC Class-7 matched *Super-Precision* spindle bearings
- #40-taper spindle for superior metal removal strength and capability
- Forward/ Reverse spindle switch housed in an oil-tight switch box
- 2 high-output spindle motor fans to provide extra cooling for long service life
- Hardened, ground & polished precision Back Gear for quiet spindle operation

### Quill:

- Power quill feed with 3-feeds and adjustable feed stop & automatic feed trip release
- Hardened and Ground Quill – **Hard-chrome plated** for a long service life
- Quill return spring

### Machine Features:

- Hi -Torque 1.5-HP knee powerfeed included to enhance operator efficiency
- Multiple knee and table locks for superior cutting rigidity
- T-slots ground to 5/8" to fit standard workholding nuts
- Automatic Metered Lubrication for slideways and lead screws
- Spring Loaded way cover is included for added safety and protection of machine
- Built-in coolant pump is included
- Coolant & Chip-Tray is included
- Water resistant halogen lamp is included
- Inspection Report on accuracy, Instruction Manual, Tools and Tool Box all included
- Large compliment of parts and accessories in stock to ensure continued operation

**THE BEST MILLS IN THE INDUSTRY  
NOW BACKED BY A FULL - SATISFACTION GUARANTEE**

# **STANDARD GMV-5 MACHINE SPECIFICATIONS:**

## **TABLE –**

<b>Table Size:</b>	12" X 58" (305 mm X 1,473 mm)
<b>Table Weight Capacity</b>	1,500 lbs.
<b>T-slot width</b> (3 Hardened & Ground T-Slots)	5/8" ground reference edges (15.9 mm wide)

## **MACHINE TRAVELS & CAPACITY –**

<b>Table Travel – X Axis</b>	40.5" (1028 mm) (With or without Power Feed)
<b>Cross Travel – Y Axis</b>	15.75" (400 mm)
<b>Knee Travel – Z Axis</b>	16" (406 mm)
<b>Ram Travel</b>	17.7" (450 mm)
<b>Spindle Nose-to-Table Travel</b>	2" – 18" (50 – 457 mm)
<b>Quill Travel – Manual &amp; Power Feed</b>	5" (127 mm)
<b>Quill feeds – With Trip Release</b>	0.0015", 0.003", 0.006", (0.038 mm, 0.076 mm, 0.152 mm)
<b>Quill Diameter</b>	4.13" (105 mm)
<b>Leadscrews with ground pitch (X &amp; Y)</b>	.2" per rev. (5 mm) (ballscrews optional)
<b>Adjustable scale ring resolution</b>	0.001" (0.0254 mm)

## **SLIDE-WAYS**

	Hardened & Ground
<b>X-Axis – Longitudinal Table Travel</b>	Hardened & Ground Dovetail Ways
<b>Y-Axis - Cross Slide to Knee</b>	Hardened & Ground Square Box Ways
<b>Z-Axis - Knee to Column</b>	Hardened & Ground Square Box Ways

## **SPINDLE HEAD –**

<b>Head tilt</b> (Left-to-Right)	90 – 0 – 90 degrees
<b>Head tilt</b> (Front-to-Back / Up-Down)	45 – 0 – 45 degrees
<b>Head Swivel</b>	360-degrees
<b>Spindle Motor</b>	5-HP, 3-Phase 220 vac
<b>Spindle Taper</b>	NT #40-taper
<b>Spindle Runout</b>	0.0002" maximum runout (0.005 mm)
<b>Spindle Bearings</b>	ABEC-7 matched set of Class-7 bearings
<b>Variable Speed Drive - Dual Range</b>	80 - 520 rpm (low-range) / 600 – 4,000 rpm (high-range)

**Note:** 5,000-RPM Spindle available w/ the optional AC Inverter Spindle Head

## **DIMENSIONS & WEIGHT –**

<b>3-Phase Power Requirements</b>	220 vac, 26-amps
<b>Coolant Capacity</b>	13.5-Gallons (51 liters)
<b>Machine Weight</b>	3,740 lbs.
<b>Machine Layout</b>	Width – 58" Depth – 68" – Height – 90.25"

– **ONE FULL YEAR WARRANTY PROVIDED –**

- Specifications and pricing subject to change without prior notice –

**THE HEAVIEST-DUTY TOOLROOM KNEE-MILL ON THE MARKET**

# GMV-5 DELUXE MACHINE:

**\$26,990.00**

**DELUXE ACCESSORY PACKAGE INCLUDED WITH EVERY MACHINE - A \$3,665 VALUE**

1.5-HP Motorized Knee Power Feed
Spring Loaded Way Covers
2-Fans to Cool Spindle Motor
Halogen Work Light
Automatic Lubrication System
Coolant Pump
Coolant & Chip Tray

## SPECIAL PACKAGE SAVINGS:

### **PACKAGE #1**

**\$29,990.00**

NEWALL/ FAGOR 3-axis Digital Readout  
Hi-Torque X-axis (table) Powerfeed (Max Torque 650 in/lb.)

### **PACKAGE #2**

**\$31,990.00**

NEWALL / FAGOR 3-axis Digital Readout  
Hi-Torque X-axis (table) Powerfeed (Max Torque 650 in/lb.)  
Y-axis (cross) Powerfeed, Air-Power Drawbar w/ safety shut-off

## **MACHINE OPTIONS**

- Factory machine installation:  
"Peace-of-Mind Factory Installation" – includes expenses \$2,995.00
- Newall 2-Axis Digital Readout installed \$2,695.00
- Newall 3-Axis Digital Readout (3<sup>rd</sup> axis is on the quill) installed \$3,495.00
- 4" Riser installed on your machine \$750.00
- 8" Riser installed on your machine \$995.00
- Wiring to 440 volts Net Price \$395.00
- Hi-Torque Longitudinal Powerfeed installed \$695.00
- Hi-Torque Cross Powerfeed installed \$795.00
- Powerpac 40 Taper Air Power Drawbar installed \$1,295.00
- Upgrade to DVS (Digital Variable Speed) P.O.R.

**A large compliment of spare parts is in stock at our facility in Chatsworth to ensure your continued operation.**

**Ganesh machines are manufactured in  
Our Certified ISO 9001 Factory in TAIWAN.**

# Floor Plan Layout

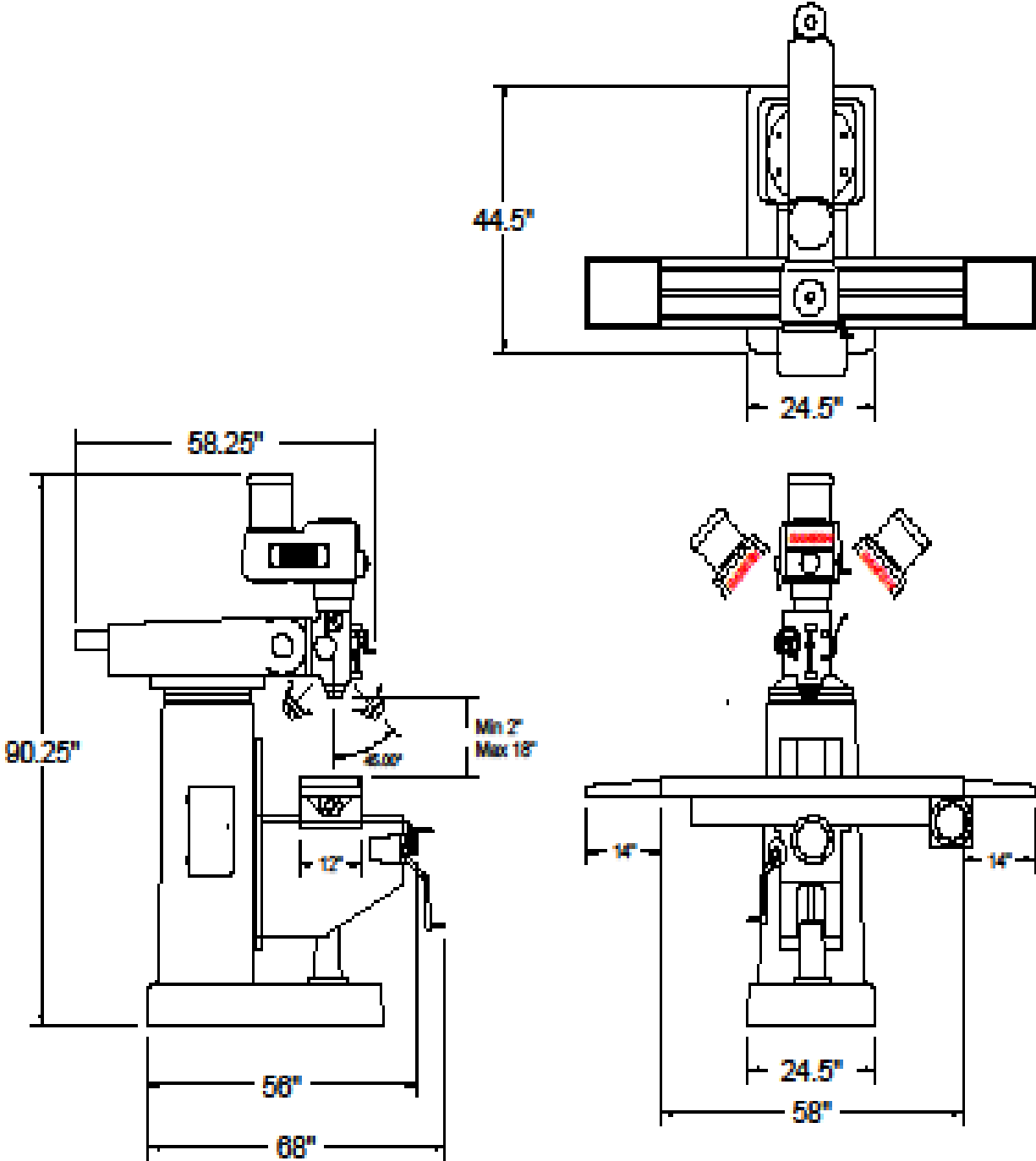

## **Terms of Sale**

**Warranty** – 1 full year parts warranty on the machine. Labor warranty will be handled by your local servicing distributor.

**Parts** – Spare parts are available at our facility in Chatsworth to support your continued machine operation.

**F.O.B. Point** – Machines ship F.O.B. from Chatsworth, CA 91311.

**Payment Terms** – 30% down payment with your Purchase Order secures the machine. 60% is due prior to machine shipment, and the 10% balance is due net-30 days after installation or the machine can be financed with our approved lender. Leases with \$1.00 buyout are available upon approved credit.

**Purchase is governed by the Expand Machinery terms and conditions of sale.**

**UL & TÜV ELECTRICAL APPROVAL IS AN AVAILABLE OPTION**

**Prices and specifications subject to change without prior notice.**